



***Almega Friendly series II***

# **Laser Tracking Sensor** ***FD-QT***

**Automatically adjusts  
the torch position  
during welding!**



***Suitable for automating  
welding work  
for large structures!***

## Automatically adjusts the torch position during welding!

### Improved welding quality

During welding, torch position, angle and welding conditions can be adjusted automatically based on the detected welding position and gap, to prevent faulty welding.

### Shorter teaching time

One teaching program suffices for parts of varying length as welding start and end points are automatically detected.

### Easy teaching

All operations can be performed from a teaching pendant. A PC is not required.

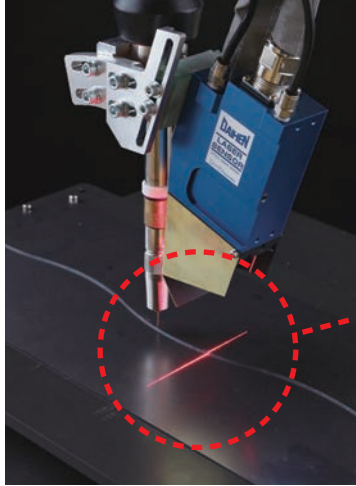

Detection status can be monitored from the teaching pendant!

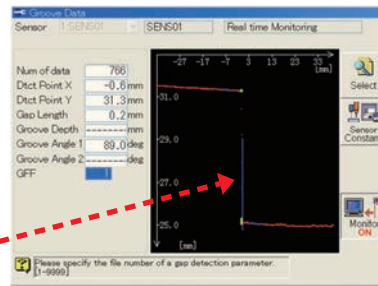

### [Basic Specifications (Sensor Head)]

Items	FD-QT
Measurement method	Synchronized laser triangulation
Standoff*2	82.5 mm
Measurement depth	65 mm
Measurement width	Near end: 23 mm Far end: 46 mm
Average resolution (Depth)	0.103 mm
Average resolution (Width)	Near end: 0.023 mm Far end: 0.040 mm
Measurement cycle (image/second)	50 images (Maximum)
Laser source	Visible red laser diode (Wavelength 660 nm)
Classification	Class 3B (Output 120 mW or less)
Dimensions (W x D x H)	215 (W) x 53 (D) x 89 (H) mm (including protrusions)
Weight	0.89 kg
Working ambient temperature	0 to +40°C
Working ambient humidity	20 to 85%RH (No condensation)
Cooling method*3,*4	Forced air cooling with dried air
Protection for optics	Air or welding gas purge and disposable lens

- \*1 Ask for pretesting to make sure this sensor can meet your requirements, before purchasing.
- \*2 The word "standoff" is the distance between the bottom of the sensor head and the near end of the measurement range.
- \*3 Use in combination with a water-cooled torch and/or high-current welding in narrow grooves may raise the ambient temperature of the sensor head more than the specified range. In this case, we suggest the water-cooling option. Ask for pretesting to check if this can work.
- \*4 Dried air (oil and mist-free) is required. When the air contains (oil) mist, use air filters. Mist in the cooling air can cause the product to malfunction.

### FD-QT Std. Components

No.	Items
1	Robot
2	Robot Controller
3	Teaching Pendant
4	Sensor Head
5	Sensor Controller
6	Sensor Cable
7	Air Tube

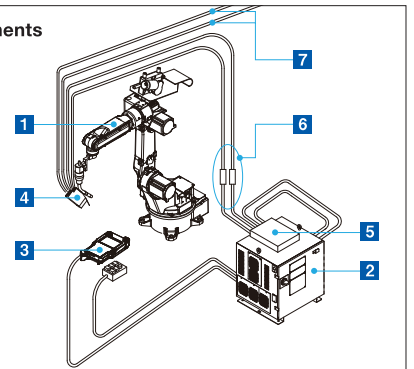

In accordance with DAIHEN's policy to make continuing improvements, design and/or specifications are subject to change without notice and without any obligation on the part of manufacturer.

### DAIHEN Corporation

4-1, Koyocho-nishi, Higashinada-ku, Kobe, Hyogo 658-0033, Japan  
 Phone: (Country Code 81) 78-275-2006  
 Fax: (Country Code 81) 78-845-8159

Distributed by:

Note | This product and the technologies (including software) used in the product are subject to Catch-All Controls. When exporting any of them, verify the users, applications, etc. according to the applicable laws and regulations and take appropriate procedures such as applications for export permission to the Minister of Economy, Trade and Industry if required.

- The information contained in this catalog is current as of November 2019 and is subject to revision without notice.
- This catalog was printed with environmentally-friendly vegetable oil ink.